

# De-Ashing systems

For household, hazardous, industrial, clinical and contaminated waste combustion systems

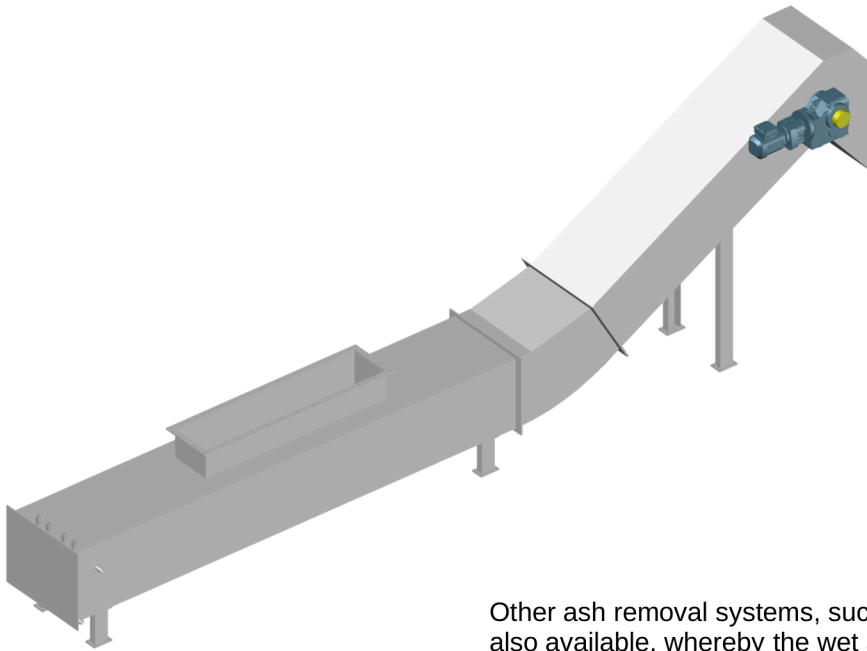

The ash is removed manually via 3 large ash removal doors or optionally via an automatic wet ash removal system.

The burnt-out ash falls behind the last grate zone through a foreseen ash shaft into the water bath of the wet de-asher and is cooled down there.

From the de-asher bath the material will be transported via a scraper conveyor to a collecting container or other requested system.

For this purpose, several standard suppliers can be used.

Other ash removal systems, such as dry ash removal systems, are of course also available, whereby the wet ash removal systems have proven themselves.

For the use of an ash removal system, the plant must be jacked up according to the ash removal system height.

All necessary components are optionally available.

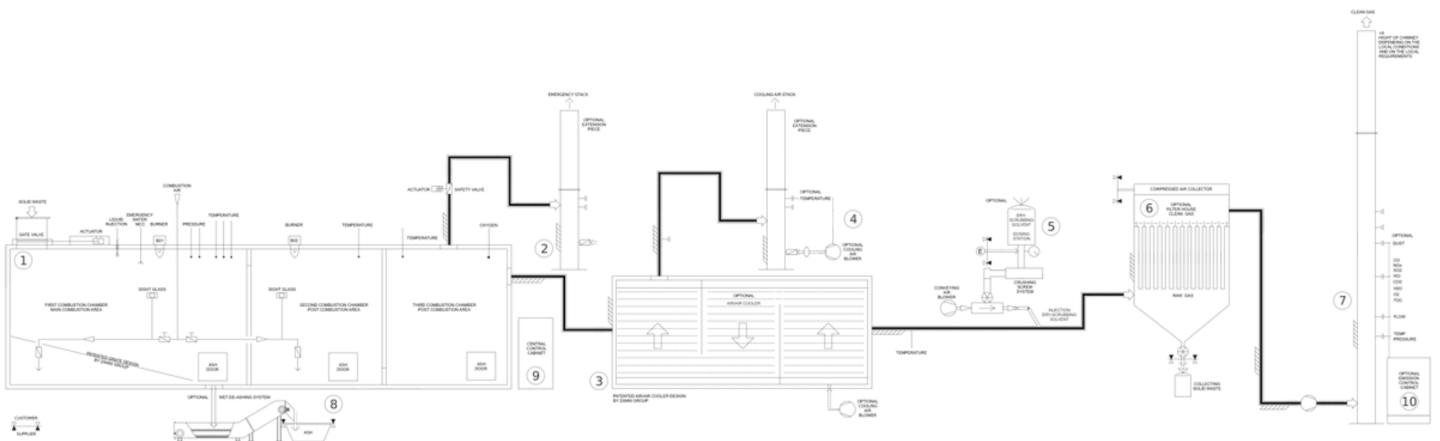

To protect the environment and to avoid unnecessary transports we would like to point out our license option.

Let's talk about it.

Thank you.

ZANNI GROUP – BRAUHOF 12 – 44866 BOCHUM – GERMANY

PLEASE VISIT [WWW.ZANNI.GROUP](http://WWW.ZANNI.GROUP)

Impressum: <https://www.zanni.de/Impressum/>